

A-A (1 : 1)

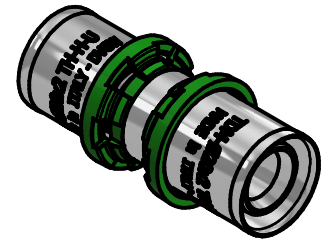
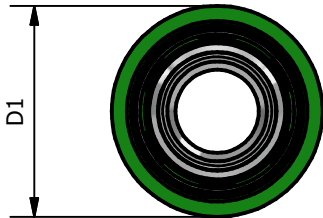
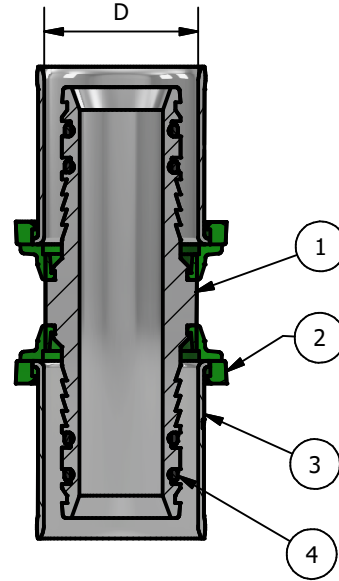
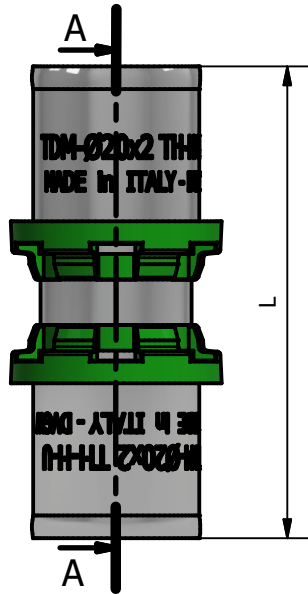

TDM CODE	SIZE	D	D1	L
2640 16	16	16x2	24	62,5
2640 18	18	18x2	26	62,5
2640 20	20	20x2	28	62,5
2640 25	25	25x2,5	34	62,5
2640 26	26	26x3	34	62,5
2640 32	32	32x3	40	64,5

N°	DESCRIPTION	MATERIAL
1	BODY	CW 617N EN 12164/65
2	INSULATION RING	NAYLON 6 (Green)
3	BUSH	AISI 304 EN 10088-2
4	O-RING	EPDM PEROX

CONFORMITY
1) DM 37 del 06/04/2004
2) UNI EN 10954-2
3) UNI EN 1254-8
4) UNI EN 12873-1

WORKING PRESSURE MAX	10 BAR
WORKING TEMPERATURE MIN- MAX	-20°C / 120°C

00	Prima emissione	Delaini M.	29/03/2021
Rev.	Nota Revisione	Approvatore	Data Approvazione
Toll Gen:	JS13	Stato sup.:	Tin plated-Stagnato
Filetto:	-	Note tecniche:	
Peso lavorato:	Peso grezzo:	N° stampo:	
Materiale:		Disegnatore:	Data: 29/03/2021
		Delaini P.	
Codice: 2640 scheda			
Descrizione: Straight fitting double			
TDM Brass s.r.l via Artigiani, 7-9 25030 Maclodio BS Italy tel +39 030 9972217 fax 030 9787089 www.tdmbrass.it email info@tdmbrass.it			

TDM BRASS
Italian Fittings